

Narrow Stile Cylinder Night Latch 1037/L1037

Application:

- For timber doors from 35 to 60mm thick, hinged on the left or right and opening inwards only
- Suitable for glass panelled doors
- Not recommended for single door entry residencies
- Concealed fixing
- Also suitable for steel and composite doors - special fixings required

Operation:

- The bolt is withdrawn by key outside and handle inside
- The bolt may be held in the locked or in the withdrawn position by operating the snib
- When the door is closed the bolt is automatically locked against end pressure by the anti-thrust slide
- Turning key a full revolution anti-clockwise deadlocks handle

Specification:

Reference	1037, L1037 (Lock case only)
Backset	40mm
Case & Keep	Zinc
Latch Bolt	Anodised Brass finish
Handle	Zinc, finished to match case and keep material
Outside Cylinder	Brass, 5 pin tumbler mechanism
Inside Cylinder	n/a
Keying Groups	May be supplied to pass, differ & master keyed. Supplied with 2 steel nickel plated keys as standard. Masterkeyed products supplied with nickel silver keys
Key Blank Number	KB8-NP



Finish shown: EB-PL

Packaging:

- Available Boxed or Visi Packed
 - * boxed only
 - ** Visi Packed only

Finishes:

Case only:

CG*; EB*; SC*; WE*;
CH*; DMG*

Case-Cylinder:

EB-PL; SC-SC; WE-PL;
WE-SC; CH-CH;
CG-PL**; DMG-CH**

Standards:



Ordering Code Example:

J 1037 - EB - PL

(Boxed - Product Code - Finish - Cylinder Finish)

Y 1037 - CH - CH

(Visi Packed - Product Code - Finish - Cylinder Finish)

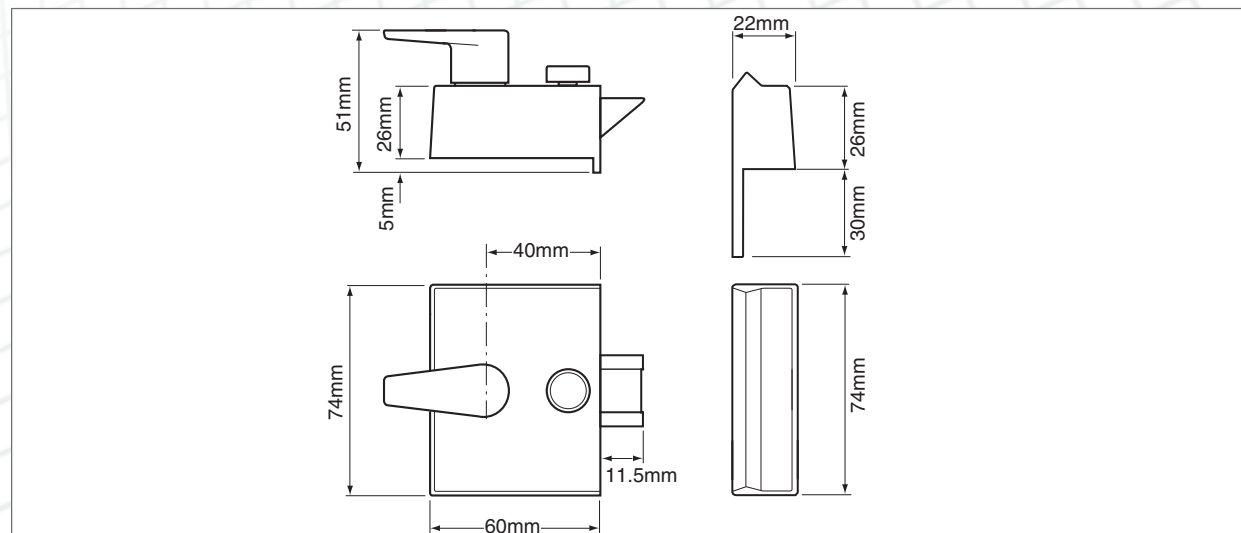

Standard Stile Cylinder Night Latch 1038/L1038

Application:

- For timber doors from 35 to 60mm thick, hinged on the left or right and opening inwards only
- Suitable for glass panelled doors
- Not recommended for single door entry residencies
- Concealed fixing
- Also suitable for steel and composite doors - special fixings required

Operation:

- The bolt is withdrawn by key outside and handle inside
- The bolt may be held in the locked or in the withdrawn position by operating the snib
- When the door is closed the bolt is automatically locked against end pressure by the anti-thrust slide
- Turning key a full revolution anti-clockwise deadlocks handle

Specification:

Reference	1038, L1038 (Lock case only)
Backset	60mm
Case & Keep	Zinc
Latch Bolt	Anodised Brass finish
Handle	Zinc, finished to match case and keep material
Outside Cylinder	Brass, 5 pin tumbler mechanism
Inside Cylinder	n/a
Keying Groups	May be supplied to pass, differ & master keyed. Supplied with 2 steel nickel plated keys as standard. Masterkeyed products supplied with nickel silver keys
Key Blank Number	KB8-NP

Variants:

- 10381 - Non-deadlocking, ideal for use in hotels and institutions. The snib retains bolt in withdrawn position.



Finish shown: WE-SC

Packaging:

- Available Boxed or Visi Packed
- * boxed only ** Visi Packed only

Finishes:

1038: Case only:	Case-Cylinder:
CG*; EB*; SC*; WE*;	CG-PL; EB-PL; SC-SC;
CH*; DMG*	WE-PL; WE-SC; CH-CH
	DMG-CH**
10381: case only:	Case-Cylinder:
Only supplied complete with cylinder	EB-PL*; WE-PL*;
	WE-SC*

Standards:



Ordering Code Example:

J 1038 - CG - PL
(Boxed - Product Code - Finish - Cylinder Finish)
Y 1038 - SC - SC
(Visi Packed - Product Code - Finish - Cylinder Finish)

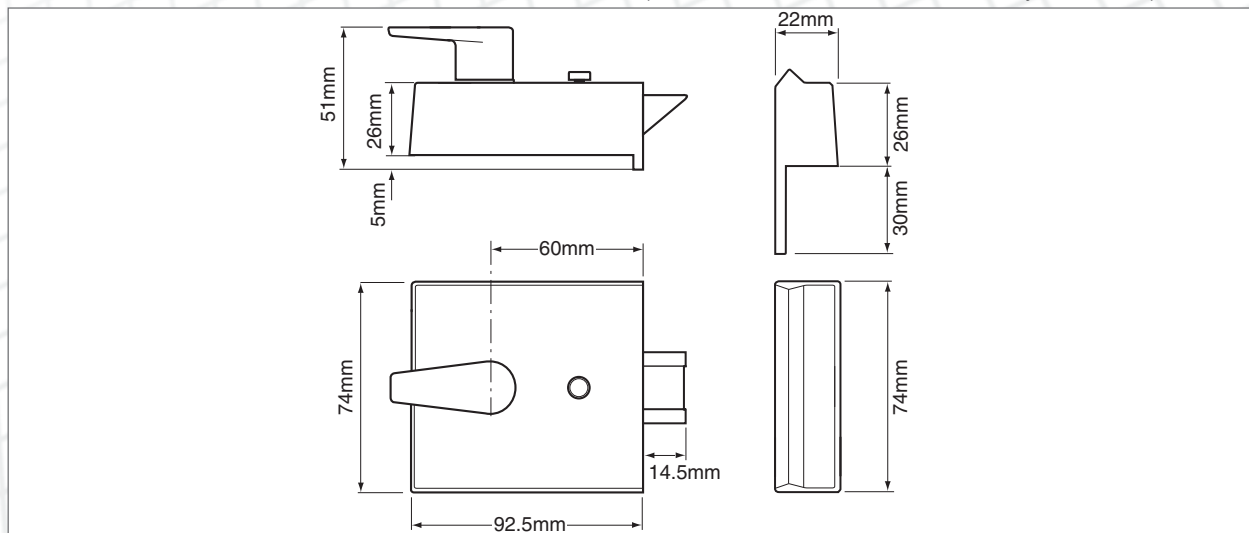

Narrow Stile Cylinder Night Latch 1047/L1047

Application:

- For timber doors from 35 to 60mm thick, hinged on the left or right and opening inwards only
- Suitable for glass panelled doors
- Not recommended for single door entry residencies
- Concealed fixing
- Also suitable for steel and composite doors - special fixings required

Operation:

- The bolt is withdrawn by key outside and handle inside
- The bolt may be held in the locked or in the with drawn position by operating the snib
- Turning key a full revolution anti-clockwise deadlocks handle and bolt

Specification:

Reference	1047, L1047 (Lock case only)
Backset	40mm
Case & Keep	Zinc
Latch Bolt	Anodised Brass finish
Handle	Zinc, finished to match case and keep material
Outside Cylinder	Brass, 5 pin tumbler mechanism
Inside Cylinder	n/a
Keying Groups	May be supplied to pass, differ & master keyed. Supplied with 2 steel nickel plated keys as standard. Masterkeyed products supplied with nickel silver keys
Key Blank Number	KB8-NP



Packaging:

- Available Boxed or Visi Packed
* boxed only

Finishes:

Case only:

CG*; EB*; SC*; WE*;
CH*; DMG*

Case-Cylinder:

CG-PL; EB-PL; SC-SC;
WE-PL; WE-SC*;
DMG-CH; CH-CH

Standards:



Ordering Code Example:

J 1047 - CG - PL

(Boxed - Product Code - Finish - Cylinder Finish)

Y 1047 - EB - PL

(Visi Packed - Product Code - Finish - Cylinder Finish)

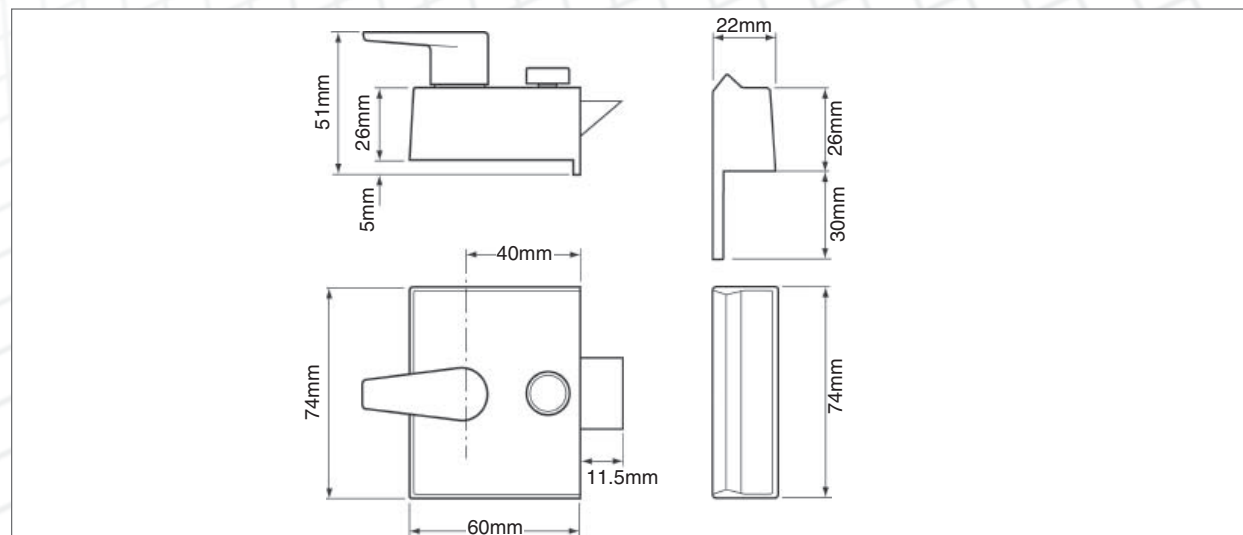

Standard Stile Cylinder Night Latch 1048/L1048

Application:

- For timber doors from 35 to 60mm thick, hinged on the left or right
- Suitable for glass panelled doors
- Not recommended for single door entry residencies
- Concealed fixing
- Also suitable for steel and composite doors - special fixings required

Operation:

- The bolt is withdrawn by key outside and handle inside
- The bolt may be held in the locked or in the withdrawn position by operating the snib
- Turning key a full turn anti-clockwise deadlocks the handle and bolt

Specification:

Reference	1048, L1048 (Lock case only)
Backset	60mm
Case & Keep	Zinc
Latch Bolt	Anodised Brass finish
Handle	Zinc, finished to match case and keep material
Outside Cylinder	Brass, 5 pin tumbler mechanism
Inside Cylinder	n/a
Keying Groups	May be supplied to pass, differ & master keyed. Supplied with 2 steel nickel plated keys as standard. Masterkeyed products supplied with nickel silver keys
Key Blank Number	KB8-NP



Finish shown: WE-SC

Packaging:

- Available Boxed or Visi Packed
* boxed only

Finishes:

Case only:

CG*; EB*; SC*; WE*;
CH*; DMG*

Case-Cylinder:

CG-PL; EB-PL; SC-SC;
WE-PL*; WE-SC*;
CH-CH; DMG-CH

Standards:



Ordering Code Example:

J 1048 - CG - PL

(Boxed - Product Code - Finish - Cylinder Finish)

Y 1048 - CH - CH

(Visi Packed - Product Code - Finish - Cylinder Finish)

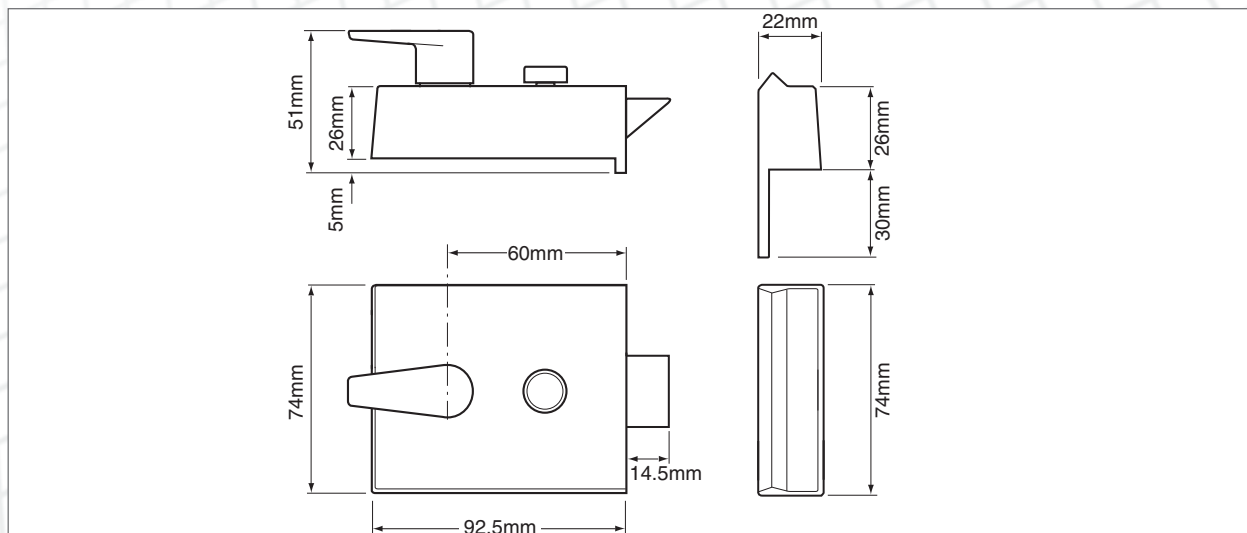

Rim Locks - Security

Standard Stile Drawback Lock Standard Stile Drawback Lock & Turn

1332/X1332
X1332T

Application:

- For timber doors from 35 to 60mm thick, hinged on the left or right and opening inwards only
- Suitable for glass panelled doors
- Also suitable for steel and composite doors - special fixings required

Operation:

- The deadbolt is double thrown, locked or unlocked by key from either side
- The latch bolt is withdrawn by key outside and handle inside
- The latch bolt may be held in by rotating handle

Specification:

Reference	1332
Backset	60mm
Case & Keep	Zinc
Deadbolt	Anodised Brass finish
Latch Bolt	Anodised Brass finish
Handle	1332 - Aluminium X1332/X1332T - Brass
	Both finished to match case and keep material
Outside Cylinder	Brass, 5 pin tumbler mechanism
Inside Cylinder	Brass, 2 pin tumbler mechanism
Keying Groups	1332 - May be supplied to pass, differ & master keyed. X1332/X1332T - May be supplied to differ only. All supplied with 3 steel nickel plated keys as standard. Masterkeyed products supplied with nickel silver keys
Key Blank Number	KB502

Packaging:

- Available Boxed or Visi Packed
- * boxed only
- ** Visi Packed only



Finish shown: WE-PL

Finishes:

Case only:

Only supplied complete with cylinder

Case-Cylinder:

(1332)

CG-PL; CG-SC*; EB-PL;
SC-SC; WE-PL*;
WE-SC*; CH-CH;
DMG-CH**

(X1332/X1332T)

BE-PL; BN-SC; SC-SC

Standards:



1332 only

Ordering Code Example:

J 1332 - CG - PL

(Boxed - Product Code - Finish - Cylinder Finish)

Y 1332 - CH - CH

(Visi Packed - Product Code - Finish - Cylinder Finish)

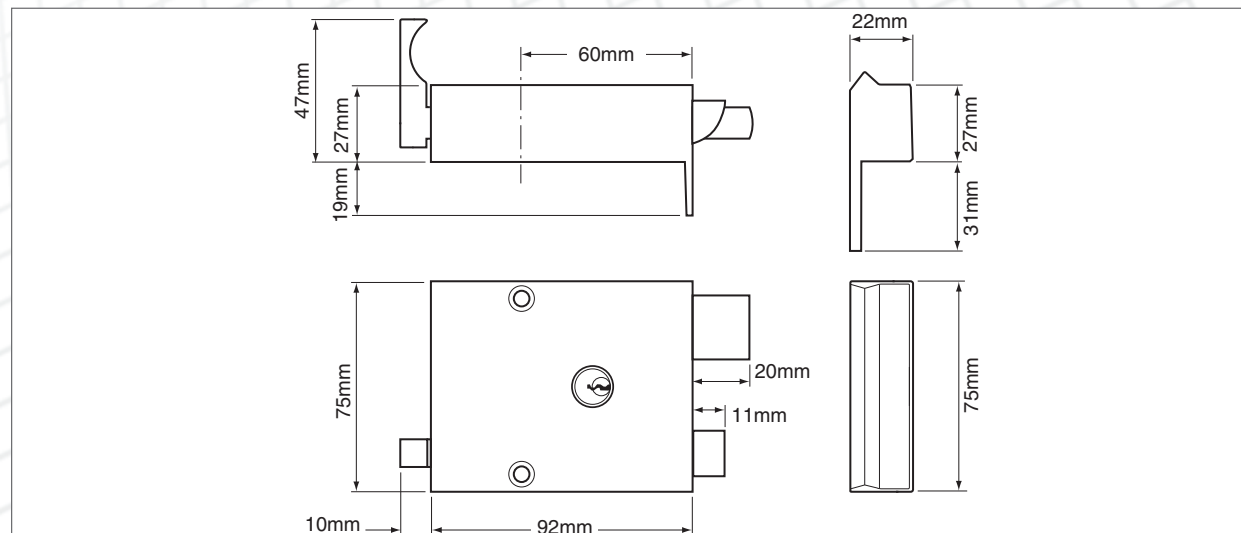

Narrow Stile Drawback Lock

1334

Application:

- For timber doors from 35 to 60mm thick, hinged on the left or right and opening inwards only
- Suitable for glass panelled doors
- Also suitable for steel and composite doors - special fixings required

Operation:

- The deadbolt is double thrown, locked or unlocked by key from either side
- The latch bolt is withdrawn by key outside and handle inside
- The latch bolt may be held in by rotating handle

Specification:

Reference	1334
Backset	50mm
Case & Keep	Zinc
Deadbolt	Anodised Brass finish
Latch Bolt	Anodised Brass finish
Handle	Aluminium, finished to match case and keep material
Outside Cylinder	Brass, 5 pin tumbler mechanism
Inside Cylinder	Brass, 2 pin tumbler mechanism
Keying Groups	May be supplied to pass and master keyed, Supplied with 3 steel nickel plated keys as standard. Masterkeyed products supplied with nickel silver keys
Key Blank Number	KB502

Packaging:

- Available Boxed or Visi Packed
- * boxed only



Finish shown: CG-PL

Finishes:

Case only:

Only supplied complete with cylinder

Case-Cylinder:

CG-PL; CG-SC*; EB-PL; SC-SC; WE-PL*; WE-SC*; CH-CH;

Standards:



Ordering Code Example:

J 1334 - CG - PL

(Boxed - Product Code - Finish - Cylinder Finish)

Y 1334 - EB - PL

(Visi Packed - Product Code - Finish - Cylinder Finish)

