

## Residential Door Furniture

# 700RRS01

### Application:

- All furniture is designed and recommended for use with UNION Mortice Locks
- Concealed wood screw fixings
- Supplied with Escutcheons

### Operation:

- Sprung lever handle mechanism

### Specification:

Reference	700RRS 01
Material	Zinc
Handle Projection	70mm
Handle Length	115mm
Rose Projection	10mm
Rose Diameter	54mm
Spindle	Steel, 8mm, square

### Finishes:

- SC - Satin Chrome
- PC - Polished Chrome
- BN - Black Nickel
- AB - Antique Brass
- PB - Polished Brass



### Standards:



- All UNION 700 Series door furniture is supplied with a 2 year guarantee

### Ordering Code Example:

J - 700RRS 01 SC

(Boxed - Product Code - Finish)

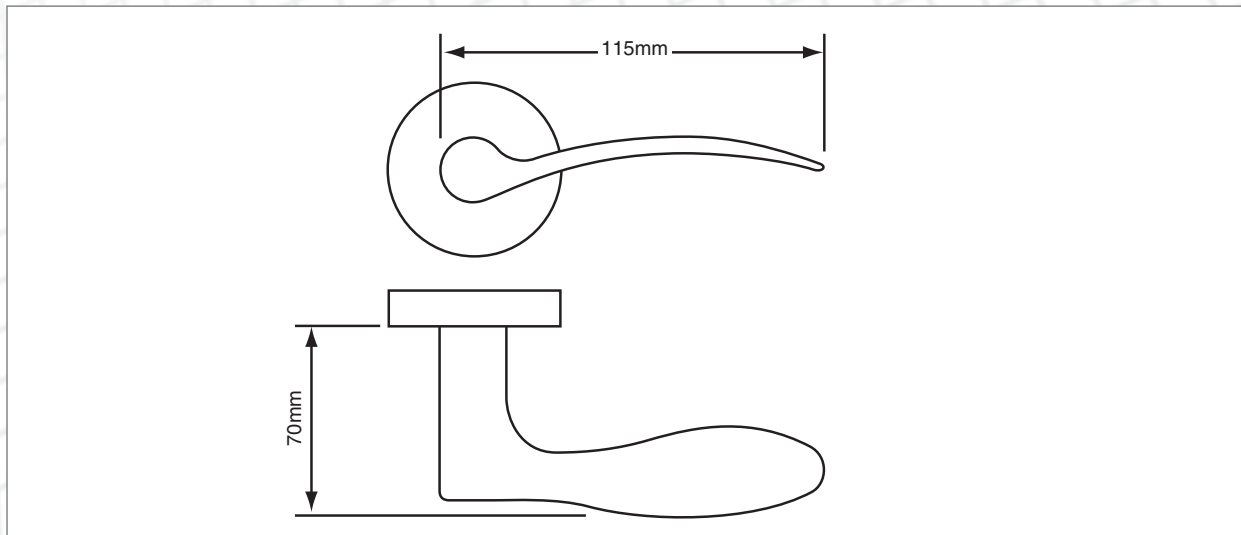

## Residential Door Furniture

# 700RRS02

5B Zinc Door Furniture

### Application:

- All furniture is designed and recommended for use with UNION Mortice Locks
- Concealed wood screw fixings
- Supplied with Escutcheons

### Operation:

- Sprung lever handle mechanism

### Specification:

Reference	700RRS 02
Material	Zinc
Handle Projection	45mm
Handle Length	115mm
Rose Projection	10mm
Rose Diameter	54mm
Spindle	Steel, 8mm, square

### Finishes:

- SC - Satin Chrome
- PC - Polished Chrome
- BN - Black Nickel
- AB - Antique Brass
- PB - Polished Brass



### Standards:



- All UNION 700 Series door furniture is supplied with a 2 year guarantee

### Ordering Code Example:

J - 700RRS 02 SC

(Boxed - Product Code - Finish)

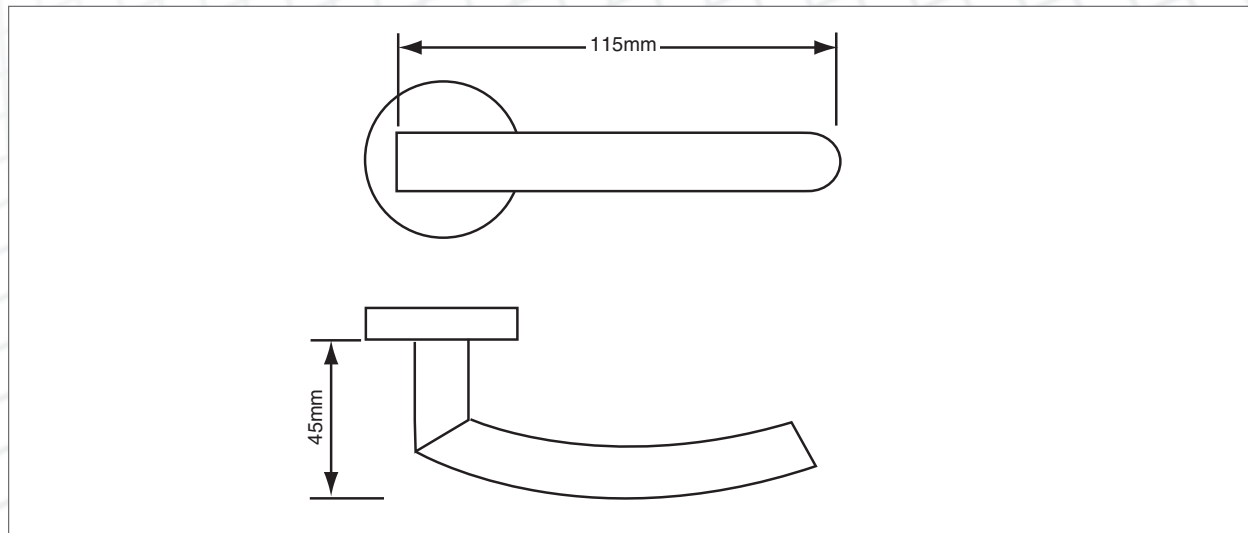

## Residential Door Furniture

## 700RRS03

### Application:

- All furniture is designed and recommended for use with UNION Mortice Locks
- Concealed wood screw fixings
- Supplied with Escutcheons

### Operation:

- Sprung lever handle mechanism

### Specification:

Reference	700RRS 03
Material	Zinc
Handle Projection	55mm
Handle Length	120mm
Rose Projection	10mm
Rose Diameter	54mm
Spindle	Steel, 8mm, square

### Finishes:

- SC - Satin Chrome
- PC - Polished Chrome
- BN - Black Nickel
- AB - Antique Brass
- PB - Polished Brass



### Standards:



- All UNION 700 Series door furniture is supplied with a 2 year guarantee

### Ordering Code Example:

J - 700RRS 03 SC

(Boxed - Product Code - Finish)

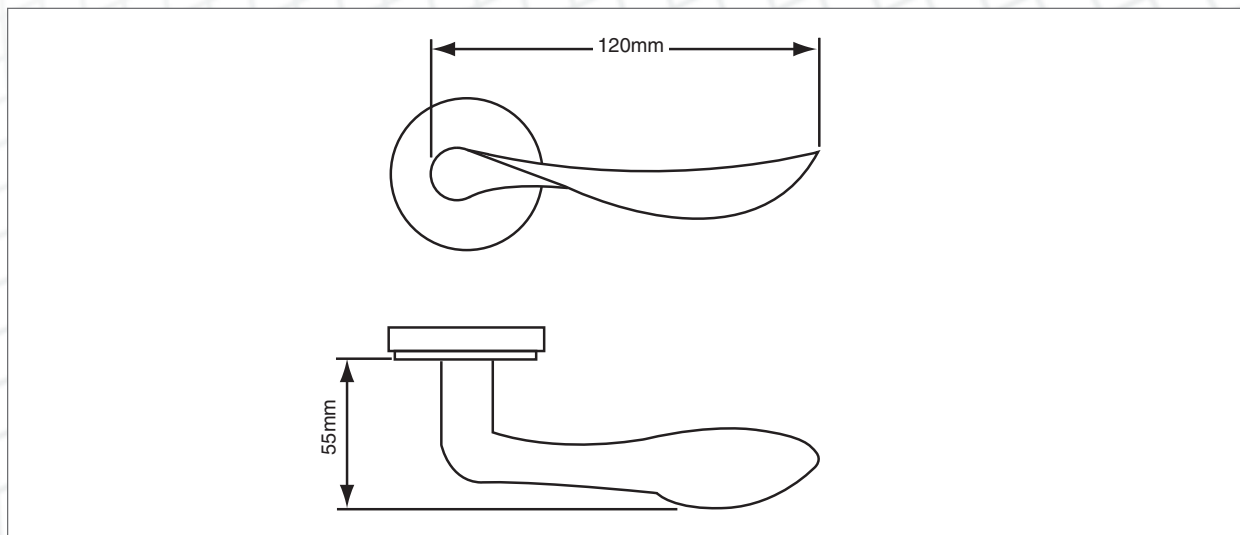

## Residential Door Furniture

# 700RRS04

5B Zinc Door Furniture

### Application:

- All furniture is designed and recommended for use with UNION Mortice Locks
- Concealed wood screw fixings
- Supplied with Escutcheons

### Operation:

- Sprung lever handle mechanism

### Specification:

Reference	700RRS 04
Material	Zinc
Handle Projection	48mm
Handle Length	115mm
Rose Projection	10mm
Rose Diameter	54mm
Spindle	Steel, 8mm, square

### Finishes:

- SC - Satin Chrome
- PC - Polished Chrome
- BN - Black Nickel
- AB - Antique Brass
- PB - Polished Brass



### Standards:



- All UNION 700 Series door furniture is supplied with a 2 year guarantee

### Ordering Code Example:

J - 700RRS 04 PB

(Boxed - Product Code - Finish)

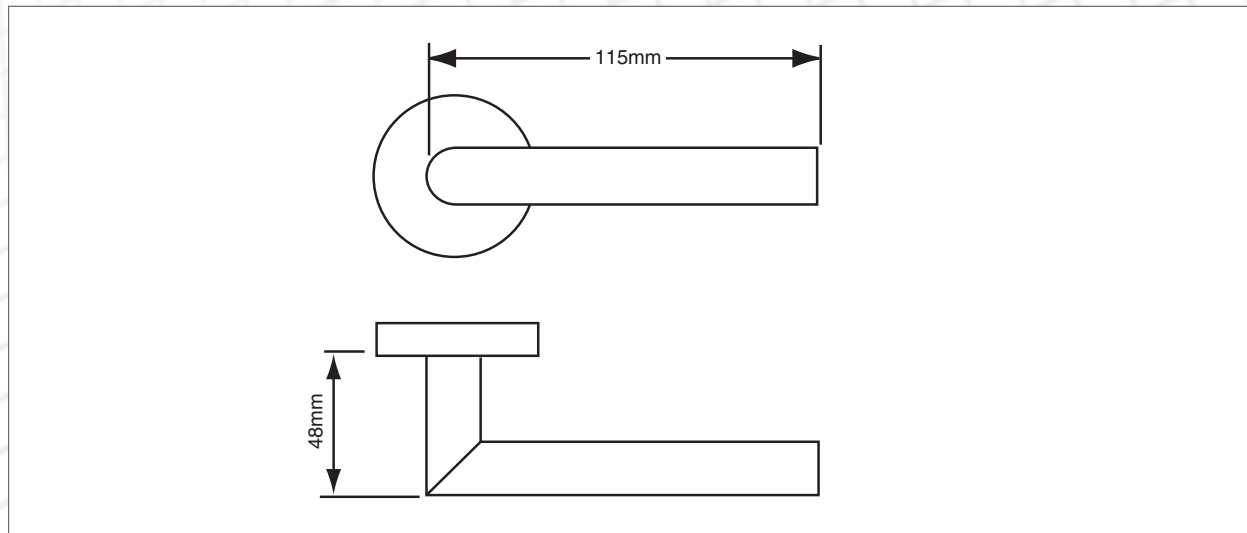

## Residential Door Furniture

# 700RRS05

### Application:

- All furniture is designed and recommended for use with UNION Mortice Locks
- Concealed wood screw fixings
- Supplied with Escutcheons

### Operation:

- Sprung lever handle mechanism

### Specification:

Reference	700RRS 05
Material	Zinc
Handle Projection	55mm
Handle Length	115mm
Rose Projection	10mm
Rose Diameter	54mm
Spindle	Steel, 8mm, square

### Finishes:

- SC - Satin Chrome
- PC - Polished Chrome
- BN - Black Nickel
- AB - Antique Brass
- PB - Polished Brass



### Standards:



- All UNION 700 Series door furniture is supplied with a 2 year guarantee

### Ordering Code Example:

J - 700RRS 05 AB

(Boxed - Product Code - Finish)

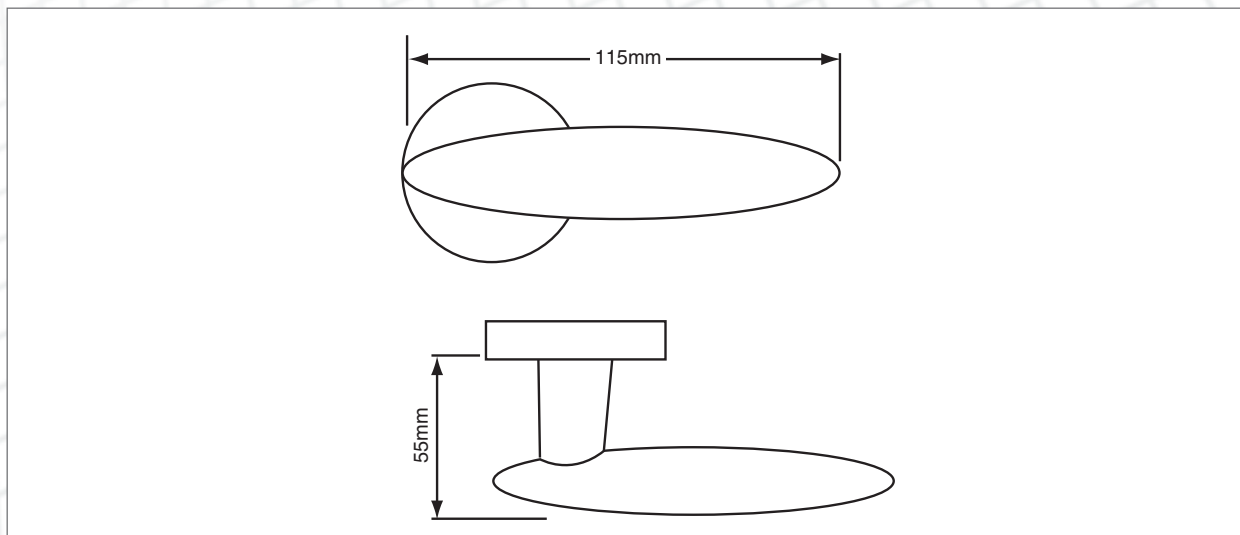

## Residential Door Furniture

## 700RRS06

5B Zinc Door Furniture

### Application:

- All furniture is designed and recommended for use with UNION Mortice Locks
- Concealed wood screw fixings
- Supplied with Escutcheons

### Operation:

- Sprung lever handle mechanism

### Specification:

Reference	700RRS 06
Material	Zinc
Handle Projection	50mm
Handle Length	105mm
Rose Projection	10mm
Rose Diameter	54mm
Spindle	Steel, 8mm, square

### Finishes:

- SC - Satin Chrome
- PC - Polished Chrome
- BN - Black Nickel
- AB - Antique Brass
- PB - Polished Brass



### Standards:



- All UNION 700 Series door furniture is supplied with a 2 year guarantee

### Ordering Code Example:

J - 700RRS 06 SC

(Boxed - Product Code - Finish)

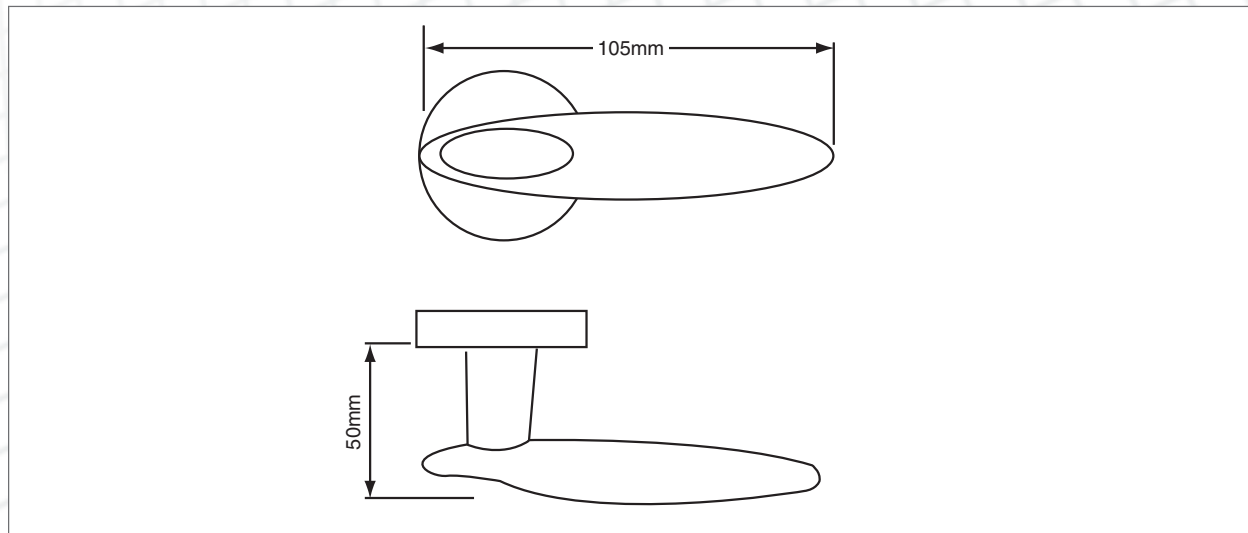

## Residential Door Furniture

# 700RRS07

### Application:

- All furniture is designed and recommended for use with UNION Mortice Locks
- Concealed wood screw fixings
- Supplied with Escutcheons

### Operation:

- Sprung lever handle mechanism

### Specification:

Reference	700RRS 07
Material	Zinc
Handle Projection	50mm
Handle Length	118mm
Rose Projection	10mm
Rose Diameter	54mm
Spindle	Steel, 8mm, square

### Finishes:

- SC - Satin Chrome
- PC - Polished Chrome
- BN - Black Nickel
- AB - Antique Brass
- PB - Polished Brass



### Standards:



- All UNION 700 Series door furniture is supplied with a 2 year guarantee

### Ordering Code Example:

J - 700RRS 07 PB

(Boxed - Product Code - Finish)

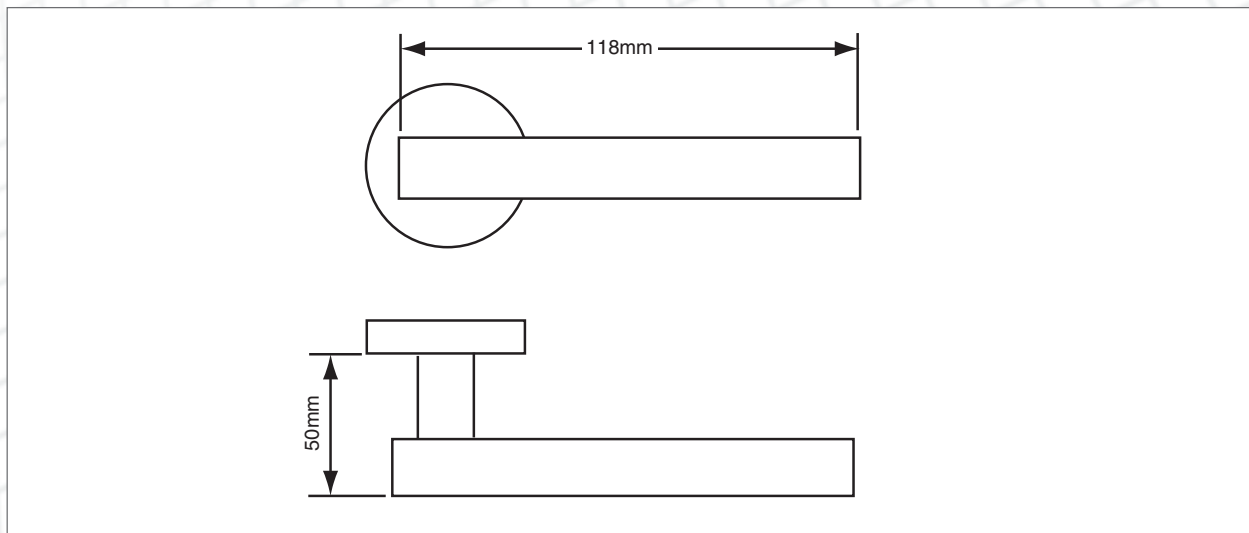

## Residential Door Furniture 700BS08ER/EP/OP

### Application:

- All furniture is designed and recommended for use with UNION Mortice Locks
- Wood screw fixings
- Supplied with backplate
- Available with 72mm, 78mm or 85mm centres

### Operation:

- Sprung lever handle mechanism

### Specification:

Reference	700BS 08 ER (Emergency Release) 700BS 08 EP (Euro Profile) 700BS 08 OP (Oval Profile)
Material	Zinc
Handle Projection	50mm
Handle Length	115mm
Plate Height	255mm
Plate Width	50mm
Spindle	Steel, 8mm, square

### Finishes:

- SC - Satin Chrome
- PC - Polished Chrome
- BN - Black Nickel
- AB - Antique Brass
- PB - Polished Brass



### Standards:



- All UNION 700 Series door furniture is supplied with a 2 year guarantee

### Ordering Code Example:

J - 700BS 08 ER SC

(Boxed - Product Code - Function - Finish)

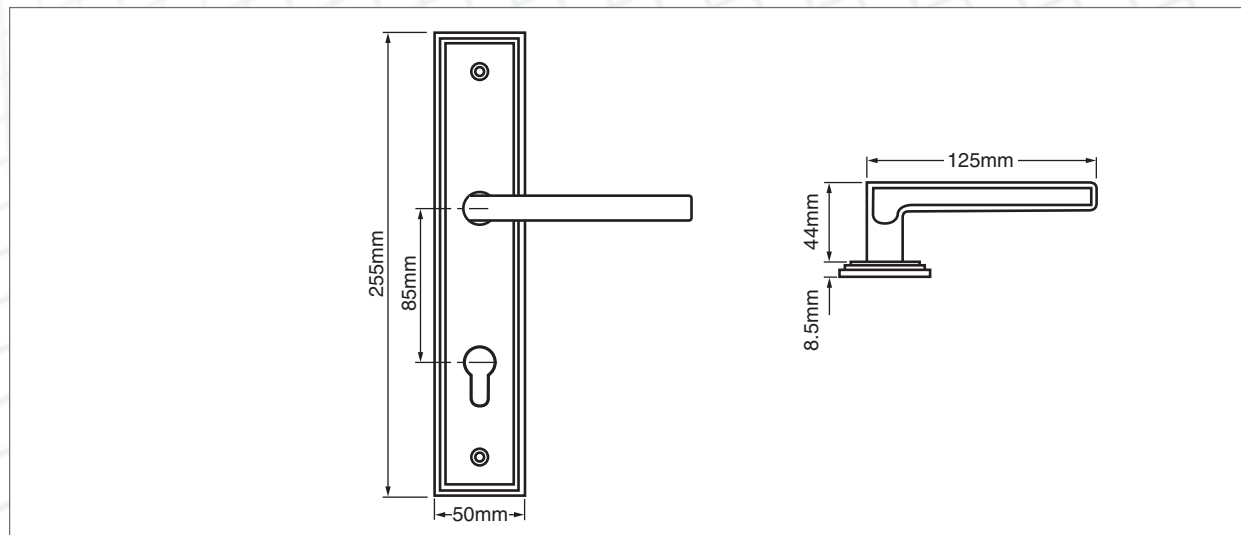

## Residential Door Furniture 700BS09ER/EP/OP

### Application:

- All furniture is designed and recommended for use with UNION Mortice Locks
- Wood screw fixings
- Supplied with backplate
- Available with 72mm, 78mm or 85mm centres

### Operation:

- Sprung lever handle mechanism

### Specification:

Reference	700BS 09 ER (Emergency Release) 700BS 09 EP (Euro Profile) 700BS 09 OP (Oval Profile)
Material	Zinc
Handle Projection	45mm
Handle Length	115mm
Plate Height	235mm
Plate Width	50mm
Spindle	Steel, 8mm, square

### Finishes:

- SC - Satin Chrome
- PC - Polished Chrome
- BN - Black Nickel
- AB - Antique Brass
- PB - Polished Brass



### Standards:



- All UNION 700 Series door furniture is supplied with a 2 year guarantee

### Ordering Code Example:

J - 700BS 09 ER PB

(Boxed - Product Code - Function - Finish)

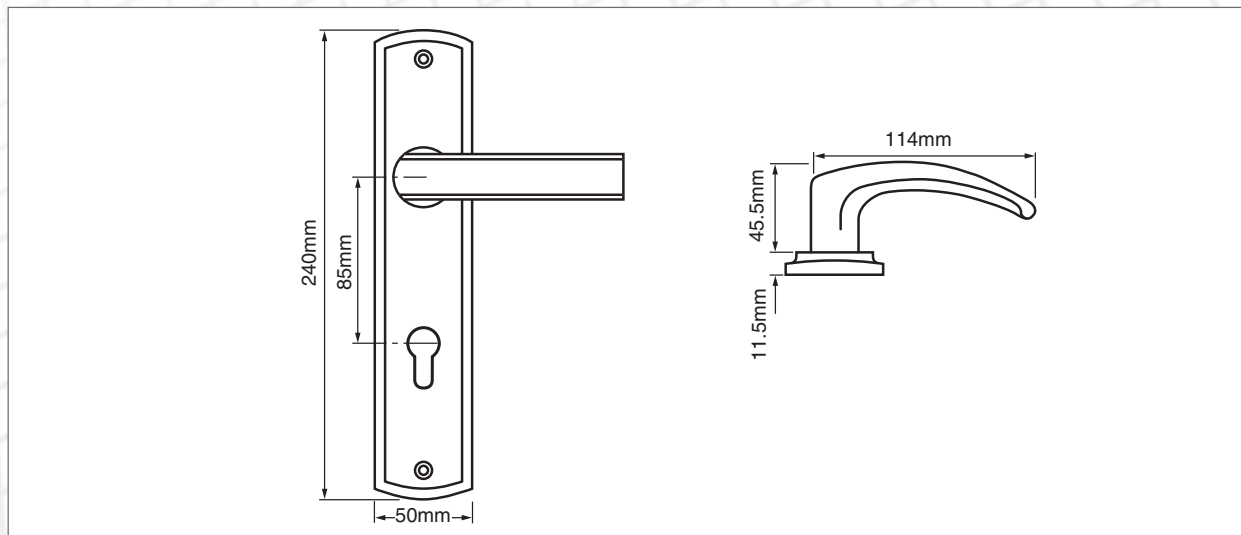

## Residential Door Furniture 700BS10ER/EP/OP

### Application:

- All furniture is designed and recommended for use with UNION Mortice Locks
- Wood screw fixings
- Supplied with backplate
- Available with 72mm, 78mm or 85mm centres

### Operation:

- Sprung lever handle mechanism

### Specification:

Reference	700BS 10 ER (Emergency Release) 700BS 10 EP (Euro Profile) 700BS 10 OP (Oval Profile)
Material	Zinc
Handle Projection	55mm
Handle Length	115mm
Plate Height	270mm
Plate Width	45mm
Spindle	Steel, 8mm, square

### Finishes:

- SC - Satin Chrome
- PC - Polished Chrome
- BN - Black Nickel
- AB - Antique Brass
- PB - Polished Brass



### Standards:



- All UNION 700 Series door furniture is supplied with a 2 year guarantee

### Ordering Code Example:

J - 700BS 10 ER PB

(Boxed - Product Code - Function - Finish)

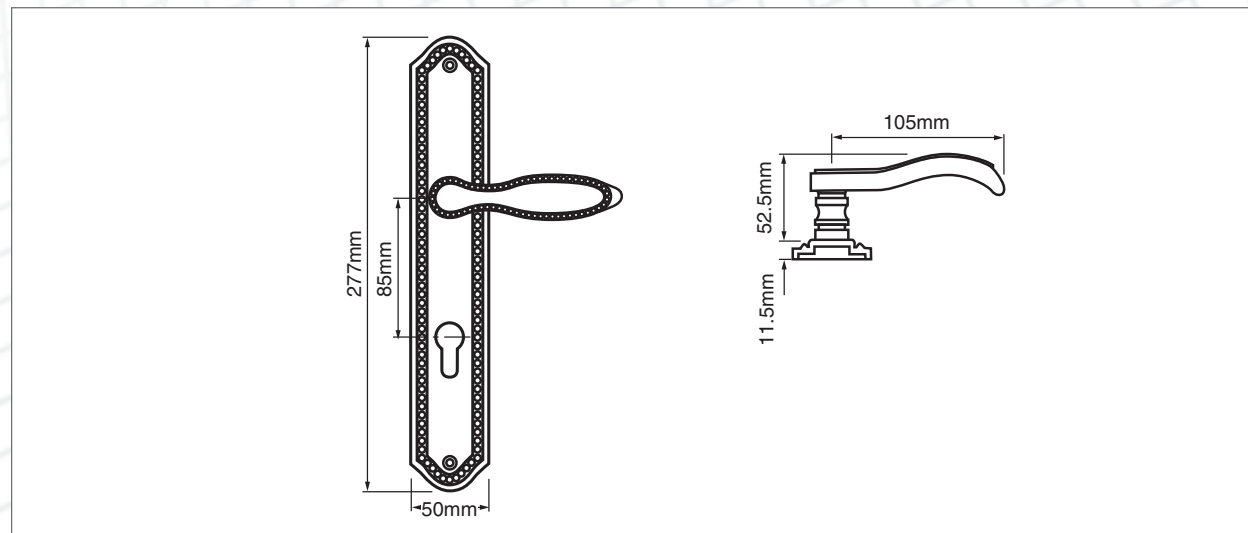

## Residential Door Furniture 700BS11ER/EP/OP

### Application:

- All furniture is designed and recommended for use with UNION Mortice Locks
- Wood screw fixings
- Supplied with backplate
- Available with 72mm, 78mm or 85mm centres

### Operation:

- Sprung lever handle mechanism

### Specification:

Reference	700BS 11 ER (Emergency Release) 700BS 11 EP (Euro Profile) 700BS 11 OP (Oval Profile)
Material	Zinc
Handle Projection	55mm
Handle Length	120mm
Plate Height	245mm
Plate Width	55mm
Spindle	Steel, 8mm, square

### Finishes:

- SC - Satin Chrome
- PC - Polished Chrome
- BN - Black Nickel
- AB - Antique Brass
- PB - Polished Brass



### Standards:



- All UNION 700 Series door furniture is supplied with a 2 year guarantee

### Ordering Code Example:

J - 700BS 11 ER AB

(Boxed - Product Code - Function - Finish)

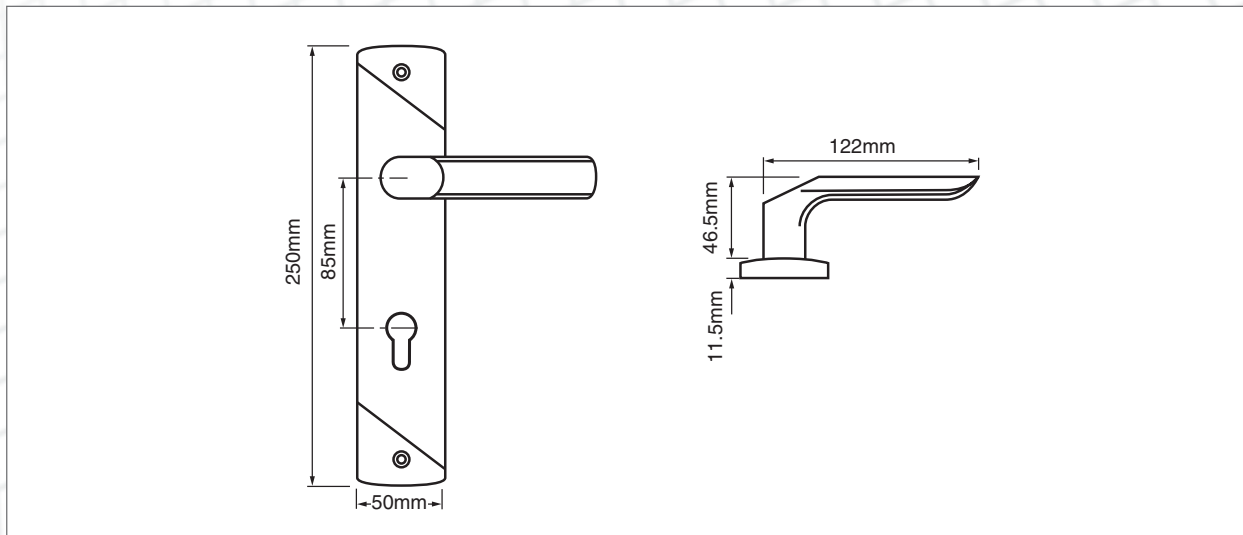

## Residential Door Furniture 700BS12ER/EP/OP

### Application:

- All furniture is designed and recommended for use with UNION Mortice Locks
- Wood screw fixings
- Supplied with backplate
- Available with 72mm, 78mm or 85mm centres

### Operation:

- Sprung lever handle mechanism

### Specification:

Reference	700BS 12 ER (Emergency Release) 700BS 12 EP (Euro Profile) 700BS 12 OP (Oval Profile)
Material	Zinc
Handle Projection	50mm
Handle Length	125mm
Plate Height	255mm
Plate Width	50mm
Spindle	Steel, 8mm, square

### Finishes:

- SC - Satin Chrome
- PC - Polished Chrome
- BN - Black Nickel
- AB - Antique Brass
- PB - Polished Brass



### Standards:



- All UNION 700 Series door furniture is supplied with a 2 year guarantee

### Ordering Code Example:

J - 700BS 12 ER SC

(Boxed - Product Code - Function - Finish)

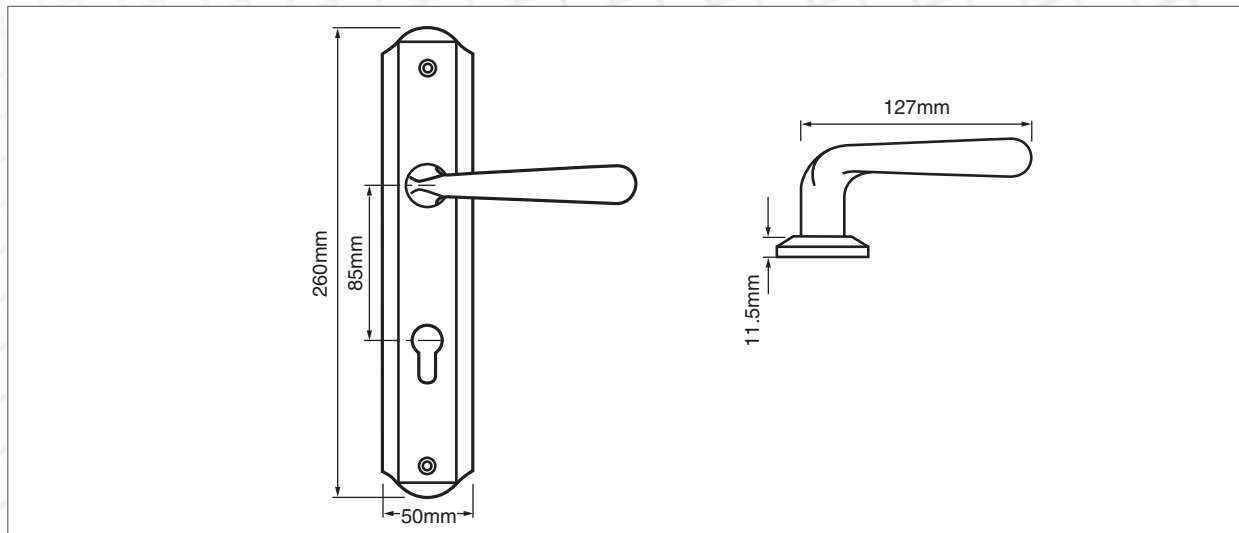

## Gower Residential Door Furniture

## 682 Series

### Application:

- Suitable for the majority of Mortice Locks
- Wood screw fixings
- Supplied with backplate
- Also available as a complete lockset

### Operation:

- Sprung lever handle mechanism

### Specification:

Reference	682-88 Long Latch Plate 682-42 Short Latch Plate 682-24 Lock Plate 682-78 Long Oval Plate 682-13 Short Oval Plate 682-73 LH Bathroom Plate 682-73 RH Bathroom Plate
Material	Zinc
Handle Projection	44mm
Handle Length	94mm (to spindle centre)
Plate Projection	7.5mm
Plate Length	178mm/152mm
Plate Width	41mm
Spindle	Steel, 8mm, square



### Finishes:

- CH - Chrome Plated

### Standards:



- All UNION 682 Series door furniture is supplied with a 5 year guarantee
- EN 1634-1 assessed for use on 60 minute timber fire doors

### Ordering Code Example:

J - 682-42-CH

(Boxed - Product Code - Finish)

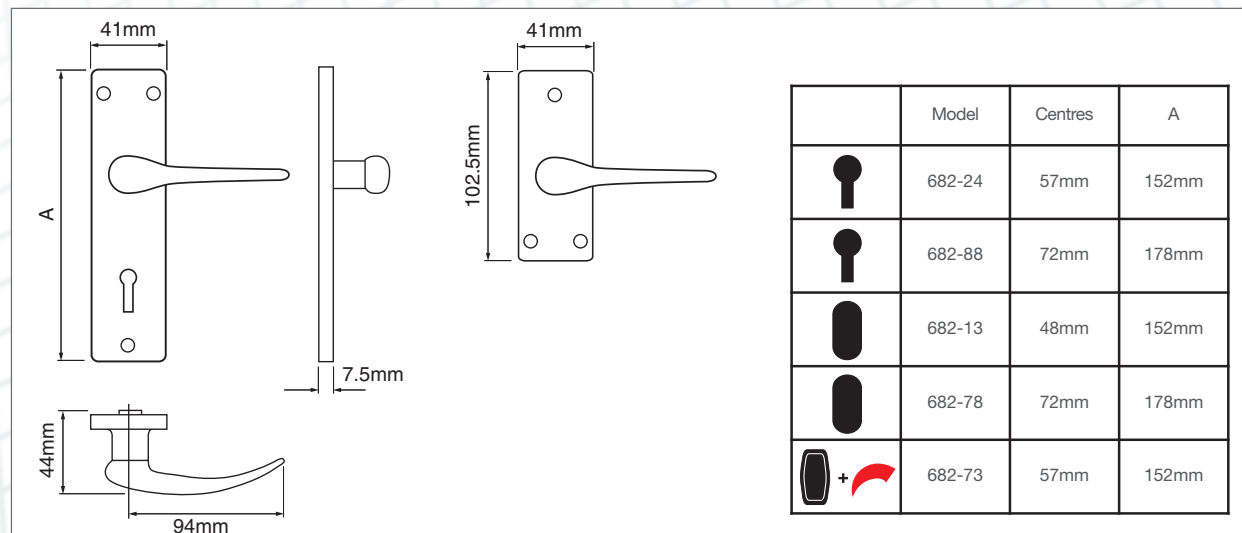

## Radius Residential Door Furniture

## 692 Series

5B Zinc Door Furniture

### Application:

- Suitable for the majority of Mortice Locks
- Wood screw fixings
- Supplied with backplate
- Also available as a complete lockset

### Operation:

- Sprung lever handle mechanism

### Specification:

Reference	692-42 Latch Plate 692-88 Long Lock Plate 692-24 Short Lock Plate 692-78 Long Oval Plate 692-13 Short Oval Plate 692-73 LH Bathroom Plate 692-73 RH Bathroom Plate
Material	Zinc
Handle Projection	44.5mm
Handle Length	85.5mm (to spindle centre)
Plate Projection	7.5mm
Plate Length	178mm/152mm
Plate Width	41mm
Spindle	Steel, 8mm, square



### Finishes:

- CH - Chrome Plated

### Standards:



- All UNION 692 Series door furniture is supplied with a 5 year guarantee
- EN 1634-1 assessed for use on 60 minute timber fire doors

### Ordering Code Example:

J - 692-42-CH

(Boxed - Product Code - Finish)

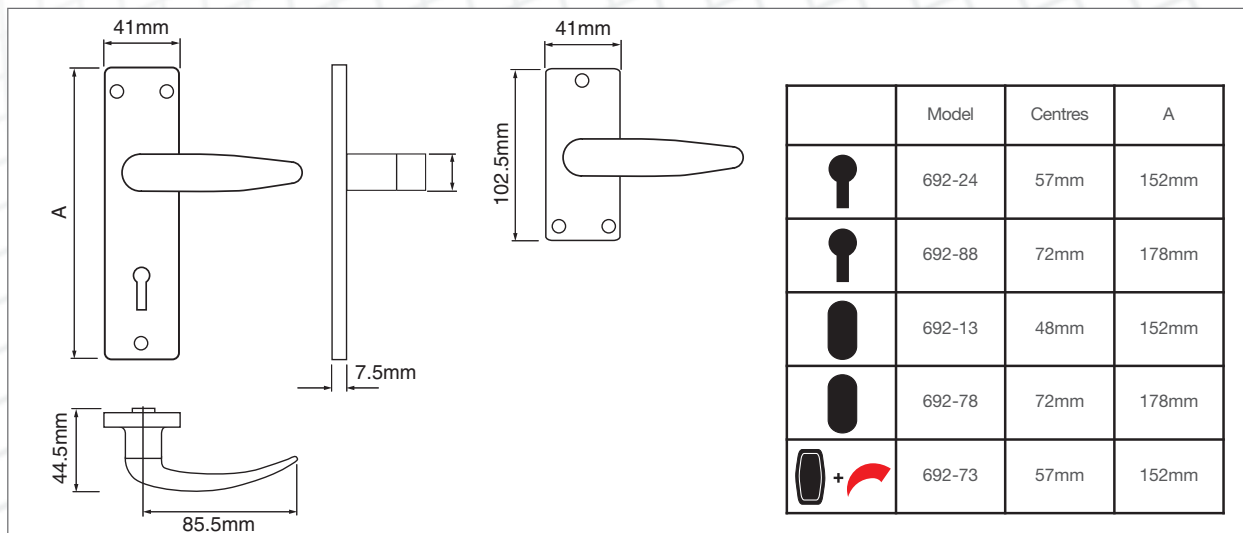

## Wedge Residential Door Furniture

## 693 Series

### Application:

- Suitable for the majority of Mortice Locks
- Wood screw fixings
- Supplied with backplate
- Also available as a complete lockset

### Operation:

- Sprung lever handle mechanism

### Specification:

Reference	693-88 Long Lock Plate 693-24 Short Lock Plate 693-78 Long Oval Plate 693-13 Short Oval Plate 693-73 LH Bathroom Plate 693-73 RH Bathroom Plate
Material	Zinc
Handle Projection	36.5/45mm
Handle Length	82.5mm (to spindle centre)
Plate Projection	7.5mm
Plate Length	152mm/203mm
Plate Width	42mm/47.5mm
Spindle	Steel, 8mm, square



### Finishes:

- CH - Chrome Plated

### Standards:



- All UNION 693 Series door furniture is supplied with a 5 year guarantee
- EN 1634-1 assessed for use on 60 minute timber fire doors

### Ordering Code Example:

J - 693-42-CH

(Boxed - Product Code - Finish)

	Model	Centres	A	B	C
	693-24	57mm	152mm	42mm	36.5mm
	693-88	72mm	203mm	47.5mm	45mm
	693-13	48mm	152mm	42mm	36.5mm
	693-78	72mm	203mm	47.5mm	45mm
	693-73	57mm	152mm	42mm	36.5mm

## Bello Residential Door Furniture

## 678 Series

5B Zinc Door Furniture

### Application:

- Suitable for the majority of Mortice Locks
- Wood screw fixings
- Supplied with backplate
- Also available as a complete lockset

### Operation:

- Sprung lever handle mechanism

### Specification:

Reference	678-24 Short Lock Plate 678-13 Short Oval Plate 678-73 Bathroom Plate
Material	Zinc
Handle Projection	52mm
Handle Length	97mm
Plate Projection	8mm
Plate Length	165mm
Plate Width	45.5mm
Spindle	Steel, 8mm, square



### Finishes:

- CH - Chrome Plated

### Standards:



- All UNION 678 Series door furniture is supplied with a 5 year guarantee
- EN 1634-1 assessed for use on 60 minute timber fire doors

### Ordering Code Example:

J - 678-24-CH

(Boxed - Product Code - Finish)

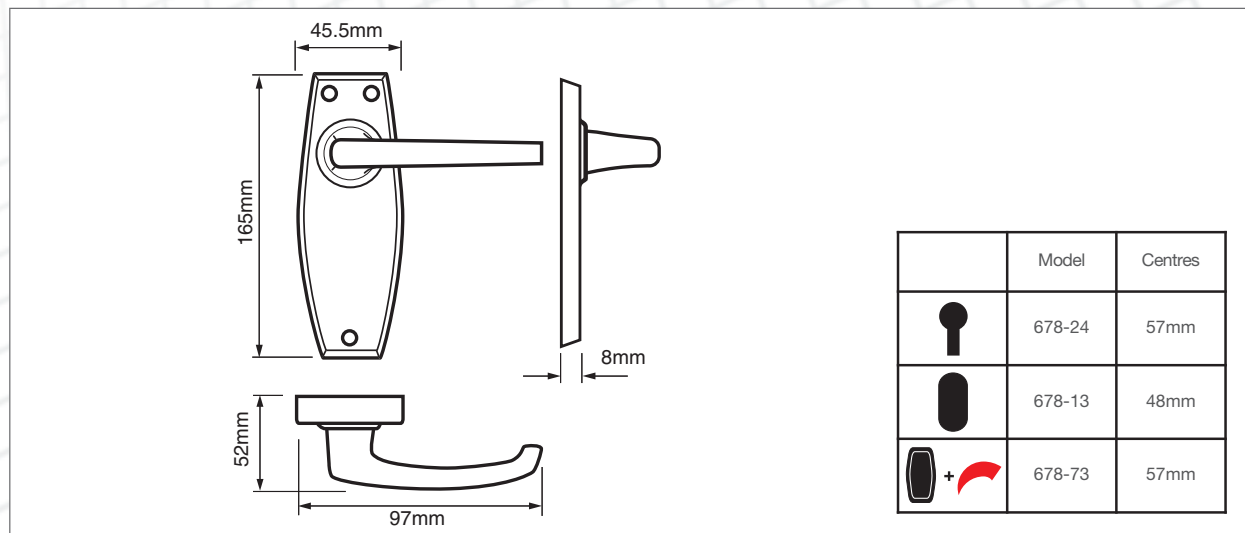

## Indicator Bolt

# 8094

### Application:

- Suitable for wooden doors between 28 and 48mm

### Specification:

Reference	8094
Bolt Projection	20mm
Body Width	66mm
Body Height	40.5mm
Body Projection	28.7mm
Indicator Width	42mm
Indicator Height	62mm
Indicator Projection	7mm
Material	Zinc

### Finishes:

- CH - Chrome finish
- EB - Electro Brass
- SC - Satin Chrome

### Standards:



### Ordering Code Example:

J 8094 - CH  
(Boxed - Product Code - Finish)

Y 8094 - CH  
(Visi packed - Product Code - Finish)