

3 Lever Horizontal Bathroom Lock

2026

Application:

- For timber doors hinged on the left or right and requiring turn and emergency release functions

Operation:

- Deadbolt locked or unlocked by separate turn from inside, or by separate emergency release from outside
- Latch bolt withdrawn by knob or sprung lever handle from either side
- Two way action, suitable for knobs or sprung lever handles (not suitable for unsprung lever handles)
- Pierced to accept bolt through furniture

Specification:

Reference	2026
Case Size	124mm (5") or 149mm (6")
Backset	38mm or 51mm
Case	Steel, silver powder coat
Forend	Stainless steel or brass
Striking Plate	Finished to match forend
Deadbolt	Brass
Latch Bolt	Brass, reversible
Follower	8mm square (Two way action) & 5mm bathroom turn follower
Rebate Kit	2939 (13mm, 19mm or 25mm)

Features:

- Reversible latch bolt
- Available with square forend and striking plate

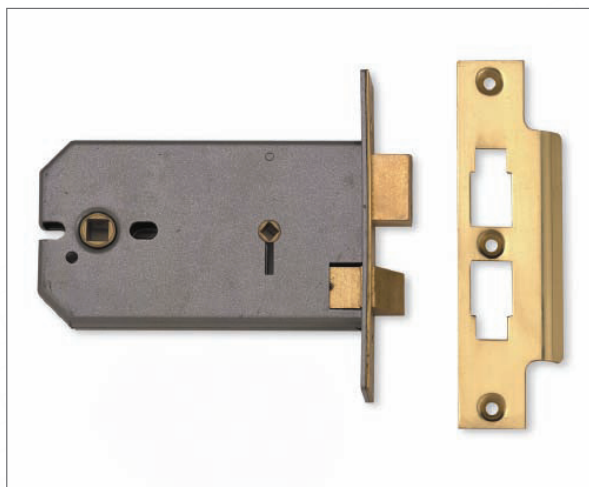

Finishes:

- SC - Satin Chrome finish
- PL - Polished Brass finish

Standards:



- EN 1634-1 assessed for use on 60 minutes timber fire doors

Ordering Code Example:

J 2026 - PL - 6.00

(Boxed - Product Code - Finish - Case Size)

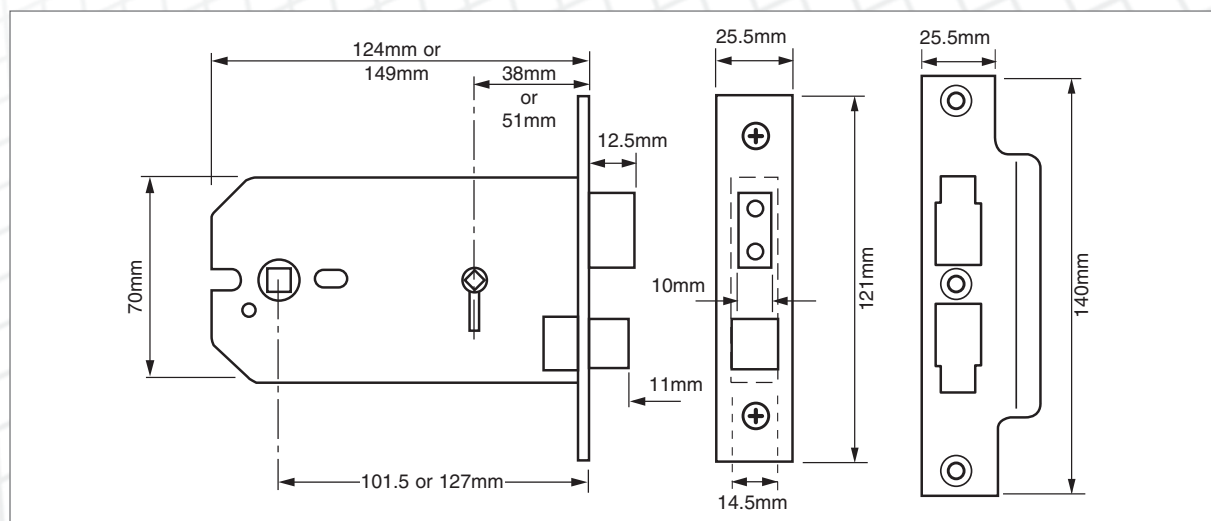

3 Lever Bathroom Deadlock

2126

Application:

- For timber doors hinged on the left or right and requiring turn and emergency release functions

Operation:

- Deadbolt locked or unlocked by separate turn from inside or by emergency release from outside

Specification:

Reference	2126
Case Size	65mm (2.5") or 77.5mm (3")
Backset	44.5mm or 57mm
Case	Steel, silver powder coat
Forend	Stainless steel or brass
Striking Plate	Finished to match forend
Deadbolt	Brass
Latch Bolt	n/a
Follower	Zinc, 5mm square
Rebate Kit	2969 (13mm, 19mm or 25mm)

Features:

- Available with square forend and striking plate

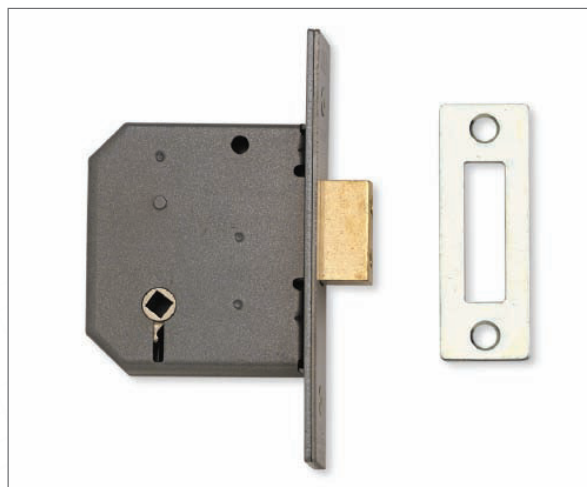

Finishes:

- SC - Satin Chrome finish
- PL - Polished Brass finish

Standards:



- EN 1634-1 assessed for use on 60 minutes timber fire doors

Ordering Code Example:

J 2126 - PL - 2.50

(Boxed - Product Code - Finish - Case Size)

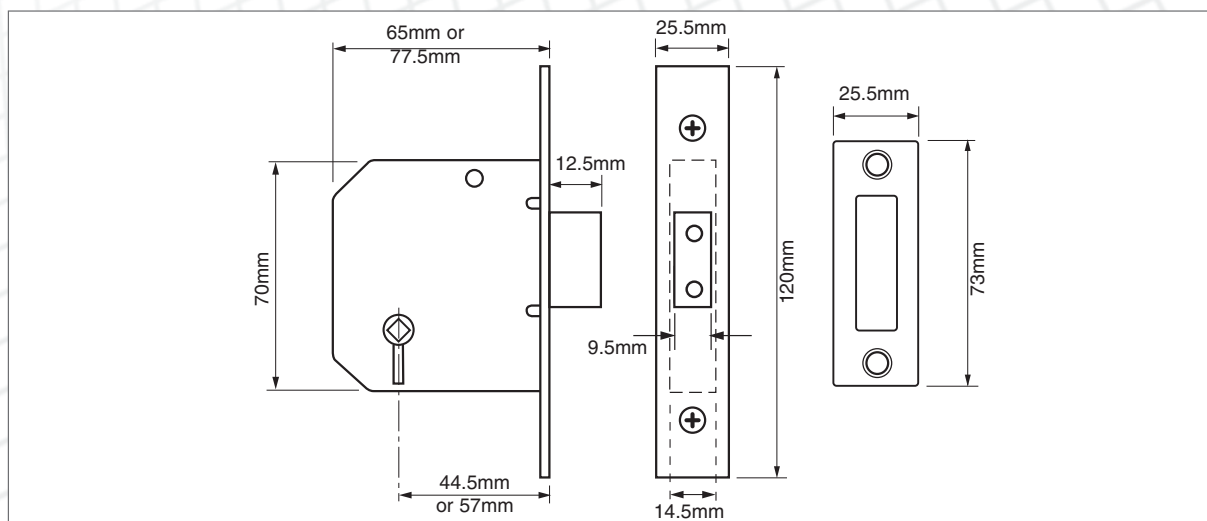

3 Lever Bathroom Lock

2226

Application:

- For timber doors hinged on the left or right, requiring turn and emergency release functions

Operation:

- Deadbolt locked or unlocked by separate turn from inside
- Deadbolt unlocked by separate emergency release from outside
- Latch bolt withdrawn by handle from either side
- Easily reversible latch bolt
- Pierced to accept bolt through furniture

Specification:

Reference	2226
Case Size	65mm (2.5"), 77.5mm (3") or 103mm (4")
Backset	44.5mm, 57mm or 82.5mm
Case	Steel, silver powder coat
Forend	Stainless steel or brass
Striking Plate	Finished to match forend
Deadbolt	Brass
Latch Bolt	Brass, reversible
Follower	Brass, 8mm square and zinc 5mm square turn follower
Rebate Kit	2979 (13mm, 19mm or 25mm)

Features:

- Reversible latch bolt
- Available with square forend and locking plate



Finishes:

- SC - Satin Chrome finish
- PL - Polished Brass finish

Standards:



- EN 1634-1 assessed for use on 60 minutes timber fire doors

Ordering Code Example:

J 2226 - PL - 2.50

(Boxed - Product Code - Finish - Case Size)

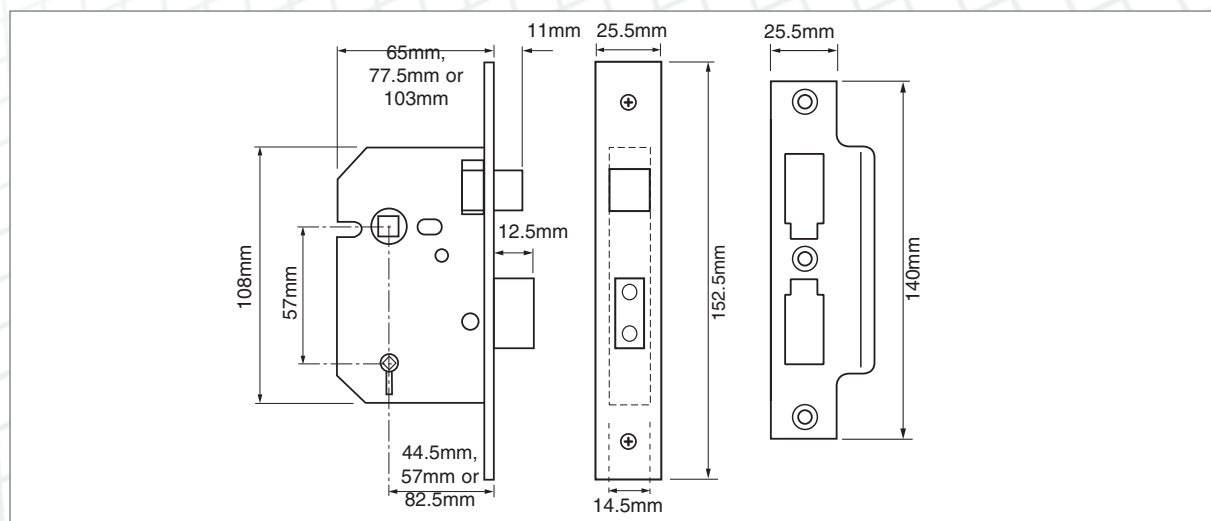

Mortice Bathroom Lock

2294

Application:

- For timber doors hinged on the left or right and requiring turn and emergency release functions

Operation:

- Deadbolt locked or unlocked by separate turn from inside
- Deadbolt unlocked by separate emergency release from outside
- Latch bolt withdrawn by lever handle from either side
- Reversible latch bolt
- Two way action suitable for lightweight knobs or sprung handles
- Not suitable for unsprung lever handles



Specification:

Reference	2294
Case Size	63mm (2.5") or 76mm (3")
Backset	44.5mm or 57mm
Case	Steel, black powder coat
Forend	Stainless steel or brass
Striking Plate	Finished to match forend
Deadbolt	Aluminium
Latch Bolt	Brass, reversible
Follower	8mm square, 5mm turn follower
Rebate Kit	n/a

NB: Not suitable for bolt through fixing

Features:

- Reversible latch bolt
- Available with square forend and striking plate

Finishes:

- CH - Chrome finish
- PL - Polished Brass finish

Standards:



- EN 1634-1 assessed for use on 60 minutes timber fire doors

Ordering Code Example:

J 2294 - PL - 2.50

(Boxed - Product Code - Finish - Case Size)

Y 2294 - PL - 2.50

(Visi Packed - Product Code - Finish - Case Size)

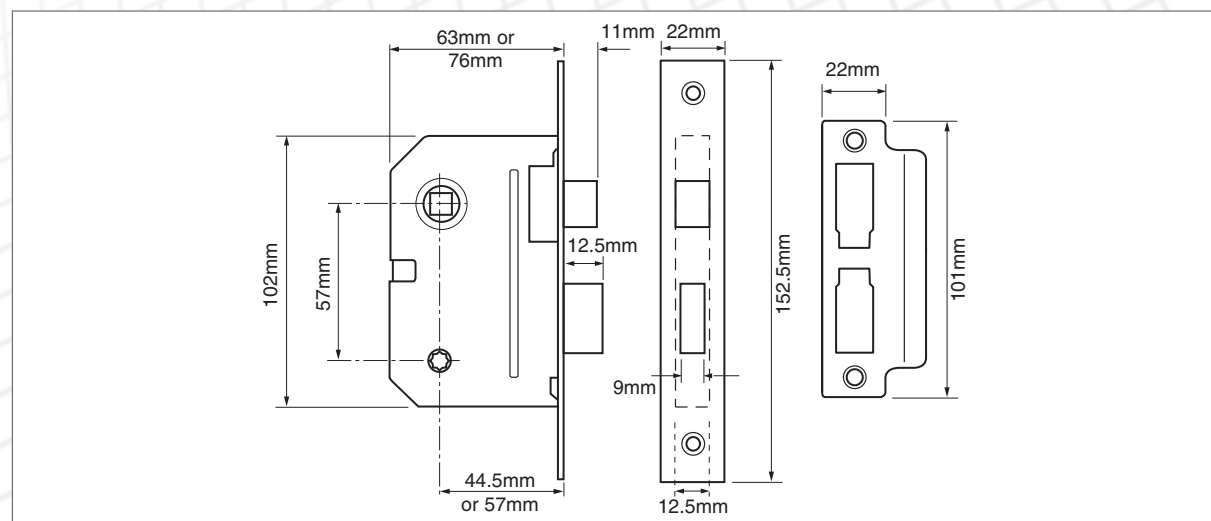

Horizontal Mortise Latch

26773

Application:

- For timber doors hinged on the left or right

Operation:

- Latch bolt withdrawn by knob or sprung lever handle from either side
- Reversible latch bolt
- Two way action for knobs or sprung lever handles
- Pierced to accept bolt through furniture
- Not suitable for unsprung lever handles

Specification:

Reference	26773
Case Size	124 (5") or 149mm (6")
Backset	101.5mm or 127mm
Case	Steel, silver powder coat
Forend	Stainless steel or brass
Striking Plate	Finished to match forend
Deadbolt	n/a
Latch Bolt	Brass, reversible
Follower	8mm square
Rebate Kit	2904 (13mm, 19mm or 25mm)

Features:

- Reversible latch bolt
- Available with square forend and locking plate

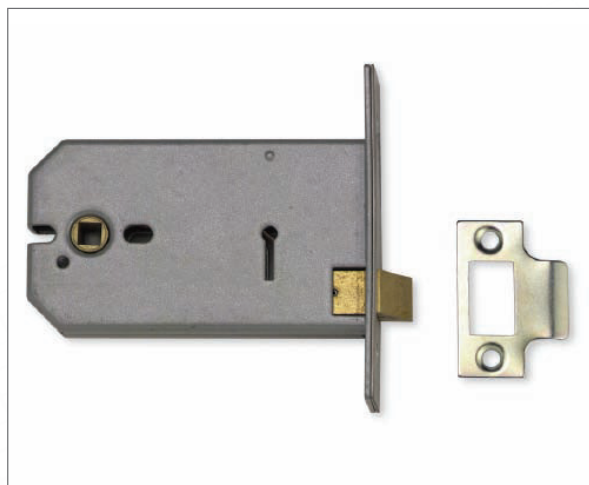

Finishes:

- SC - Satin Chrome finish
- PL - Polished Brass finish

Standards:



- EN 1634-1 assessed for use on 60 minutes timber fire doors

Ordering Code Example:

J 26773 - PL - 6.00

(Boxed - Product Code - Finish - Case Size)

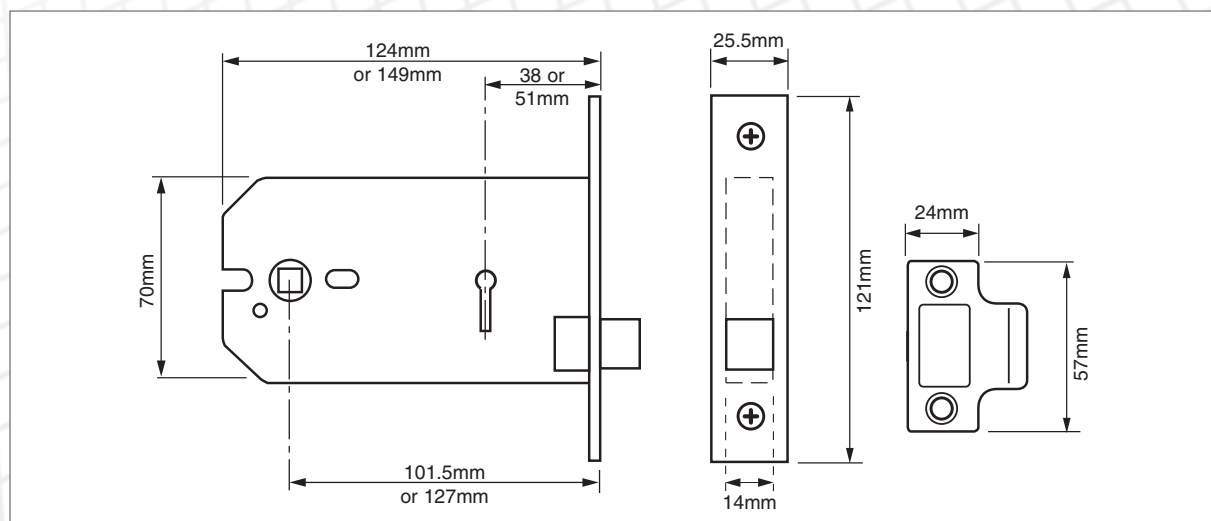

Mortice Latch

2642

Application:

- For timber doors hinged on the left or right
- Not suitable for use with unsprung lever handles

Operation:

- Latch bolt withdrawn by knob or sprung lever handles
- Two way action

Specification:

Reference	2642
Case Size	63.5mm (2.5"), 76.5mm (3") or 101.5mm (4")
Backset	44.5mm, 57.5mm or 82.5mm
Case	Steel, galvanised
Forend	Stainless steel or brass
Striking Plate	Finished to match forend
Deadbolt	n/a
Latch Bolt	Brass
Follower	8mm square
Rebate Kit	n/a

Features:

- Available with square forend and locking plate

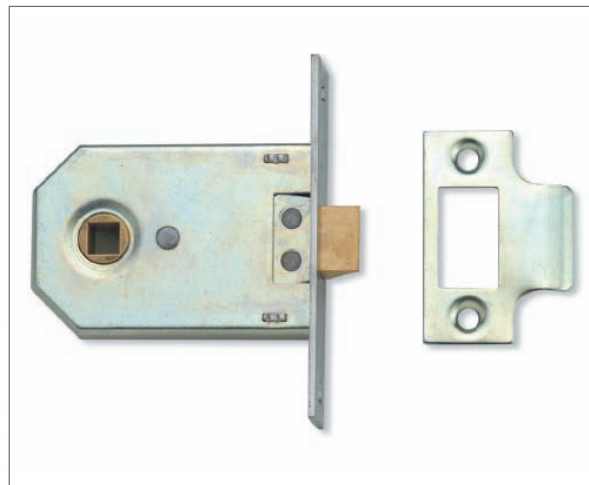

Finishes:

- CH - Polished Chrome finish
- PL - Polished Brass finish

Standards:



- EN 1634-1 assessed for use on 60 minutes timber fire doors

Ordering Code Example:

J 2642 - PL - 2.50

(Boxed - Product Code - Finish - Case Size)

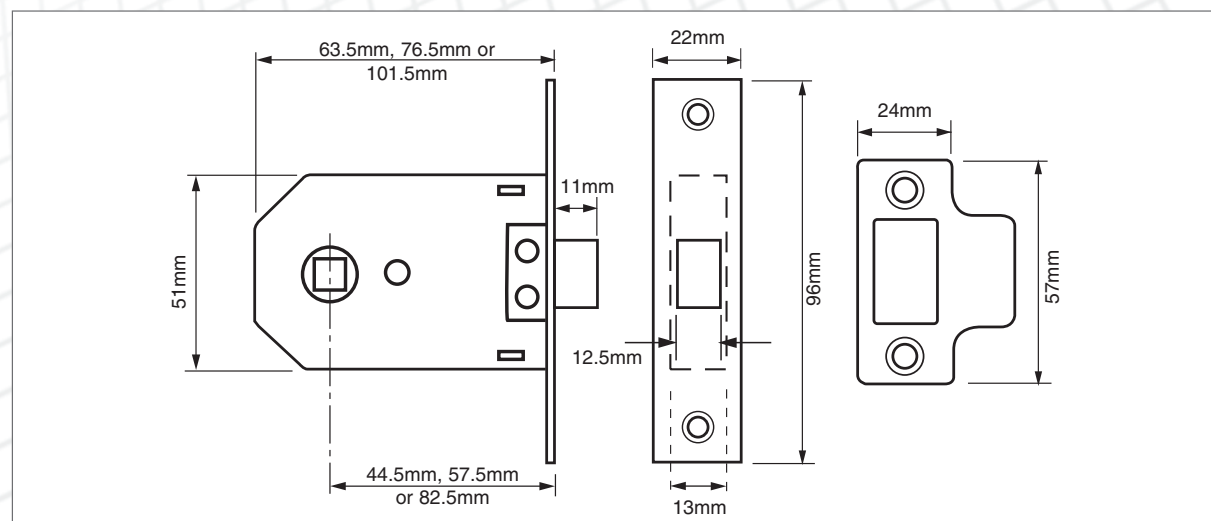

Mortice Latch

2648/2650

Application:

- For timber doors hinged on the left or right and requiring lever handle operation
- Not suitable for use with unsprung lever handles

Operation:

- Latch bolt withdrawn by sprung lever handle from either side
- Two way action
- 2650 - rebated mortice latch (suitable for 13mm rebate)

Specification:

Reference	2648 (non rebated) 2650 (rebated 13mm)
Case Size	64.5mm (2.5"), 80mm (3") or 91.5mm (3.5")
Backset	44.5mm, 57mm or 82.5mm
Case	Steel, galvanised
Forend	Stainless steel or brass
Striking Plate	Finished to match forend
Deadbolt	n/a
Latch Bolt	Black, plastic construction
Follower	8mm square
Rebate Kit	Fixed 13mm rebate on 2650

Features:

- Available with square forend and striking plate

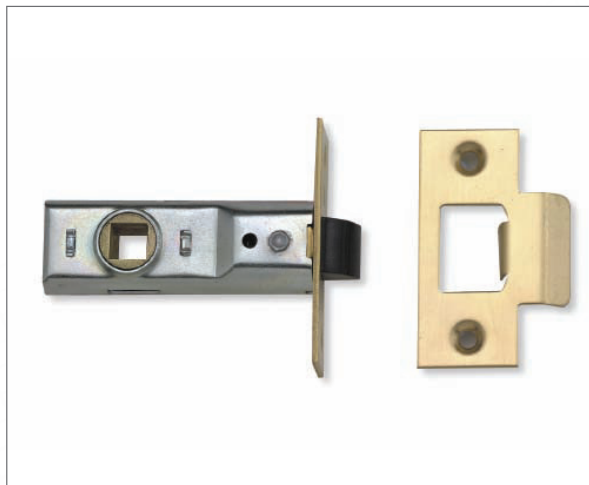

Finishes:

- 2648 - SE - Silver Enamel finish and PL - Polished Brass finish
- 2650 - EB - Electro Brass finish and SE - Silver Enamel finish

Standards:



- EN 1634-1 assessed for use on 60 minutes timber fire doors

Ordering Code Example:

J 2648 - PL - 2.50

(Boxed - Product Code - Finish - Case Size)

Y 2648 - PL - 2.50

(Visi Packed - Product Code - Finish - Case Size)

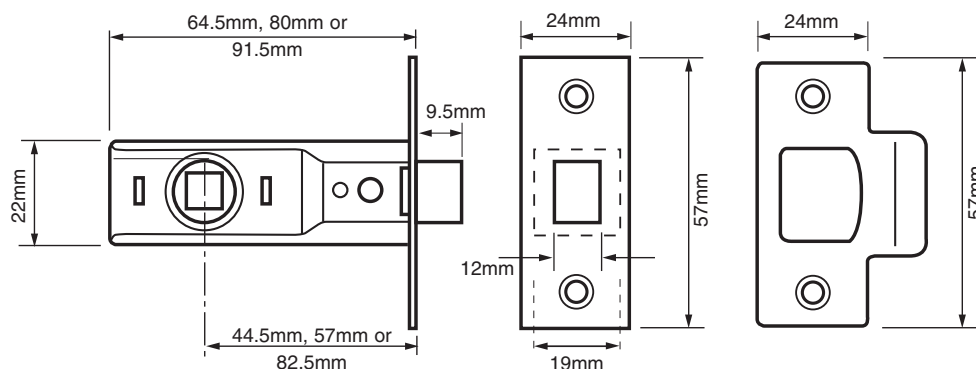

Mortice Latch

2657

Application:

- For timber doors hinged on the left or right

Operation:

- Latch bolt withdrawn by lever handle from either side
- Reversible latch bolt
- Pierced to accept bolt through furniture

Specification:

Reference	2657
Case Size	65mm (2.5"), 77.5mm (3") or 103mm (4")
Backset	44.5mm, 57mm or 82.5mm
Case	Steel, silver powder coat
Forend	Stainless steel or brass
Striking Plate	Finished to match forend
Deadbolt	n/a
Latch Bolt	Brass, reversible
Follower	Brass, 8mm square
Rebate Kit	2930 (13mm, 19mm or 25mm)

Features:

- Reversible latch bolt
- Available with square forend and locking plate



Finishes:

- SC - Satin Chrome finish
- PL - Polished Brass finish

Standards:



- EN 1634-1 assessed for use on 60 minutes timber fire doors

Ordering Code Example:

J 2657 - PL - 2.50

(Boxed - Product Code - Finish - Case Size)

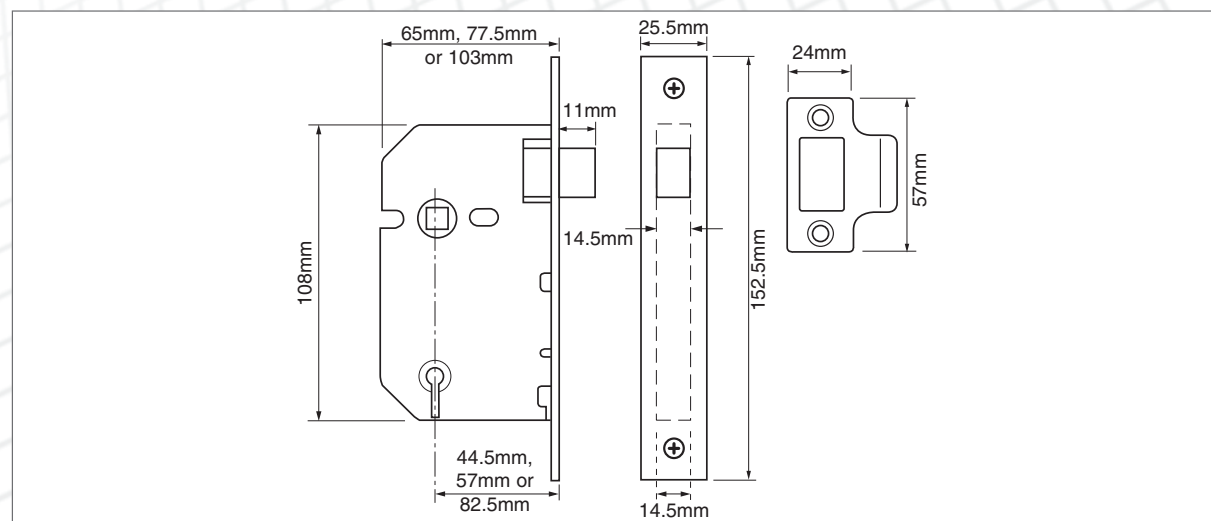

Mortice Latch

2677

Application:

- For timber doors hinged on the left or right and requiring lever handle operation

Operation:

- Latch bolt withdrawn by sprung lever handle from either side
- Reversible latch bolt
- Pierced to accept bolt through furniture

Specification:

Reference	2677
Case Size	65mm (2") or 77.5mm (3")
Backset	44mm or 57mm
Case	Steel, silver powder coat
Forend	Stainless steel or brass
Striking Plate	Finished to match forend
Deadbolt	n/a
Latch Bolt	Brass, easily reversible
Follower	8mm square
Rebate Kit	2992 (13mm, 19mm or 25mm)
Keying Groups	None

Features:

- Reversible latch bolt
- Available with square forend and striking plate

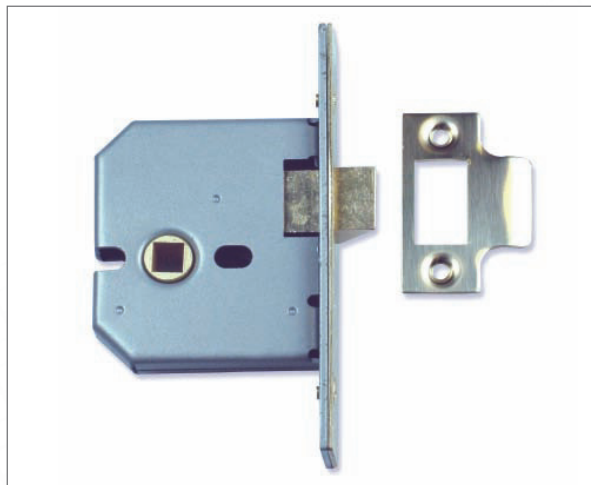

Finishes:

- SC - Satin Chrome finish
- PL - Polished Brass finish

Standards



- EN 1634-1 assessed for use on 60 minutes timber fire doors

Ordering Code Example:

J 2677 - PL - 3.00

(Boxed - Product Code - Finish - Case Size)

